

(nachrichtlich zur Unterlage 16)

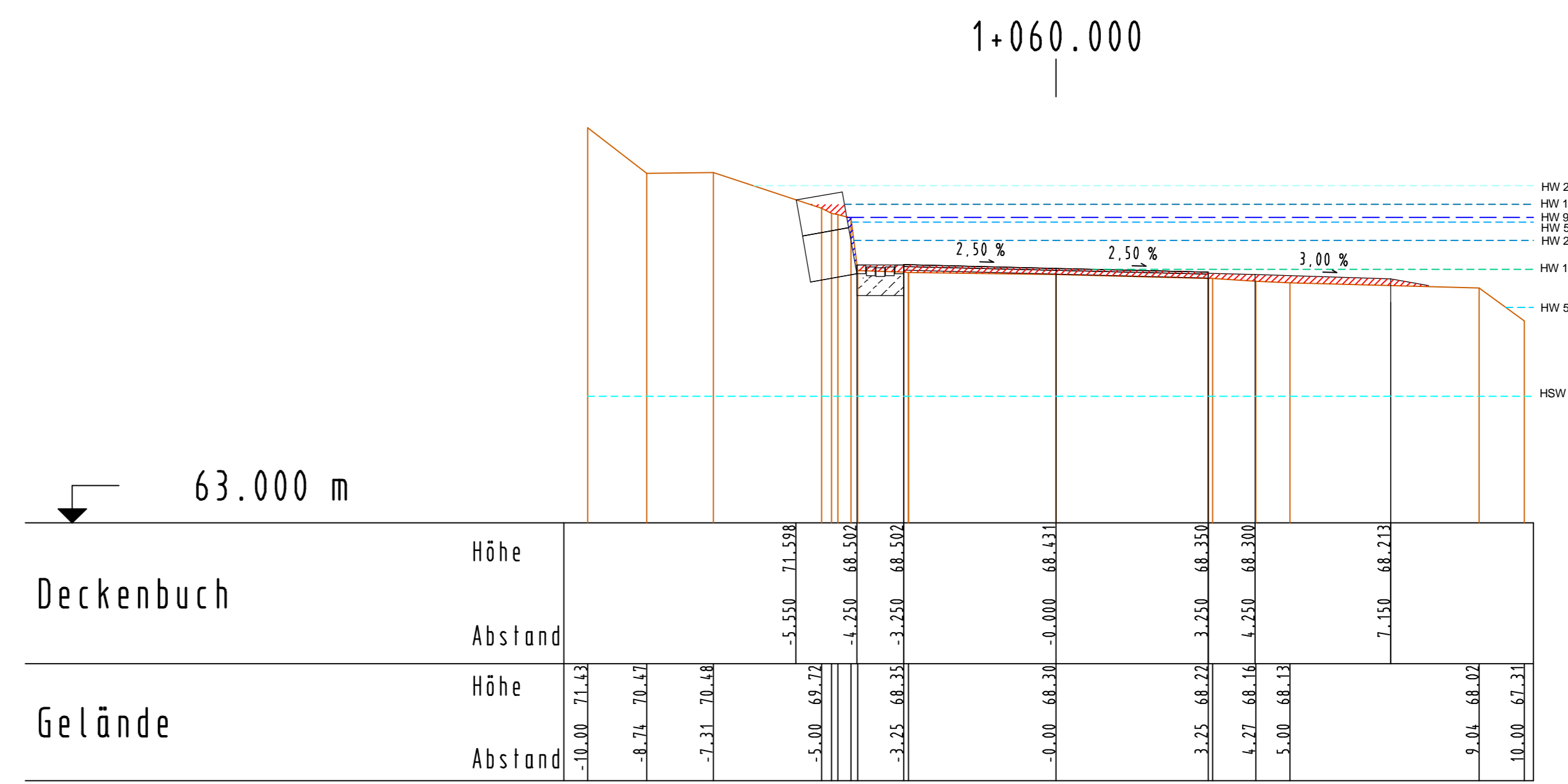
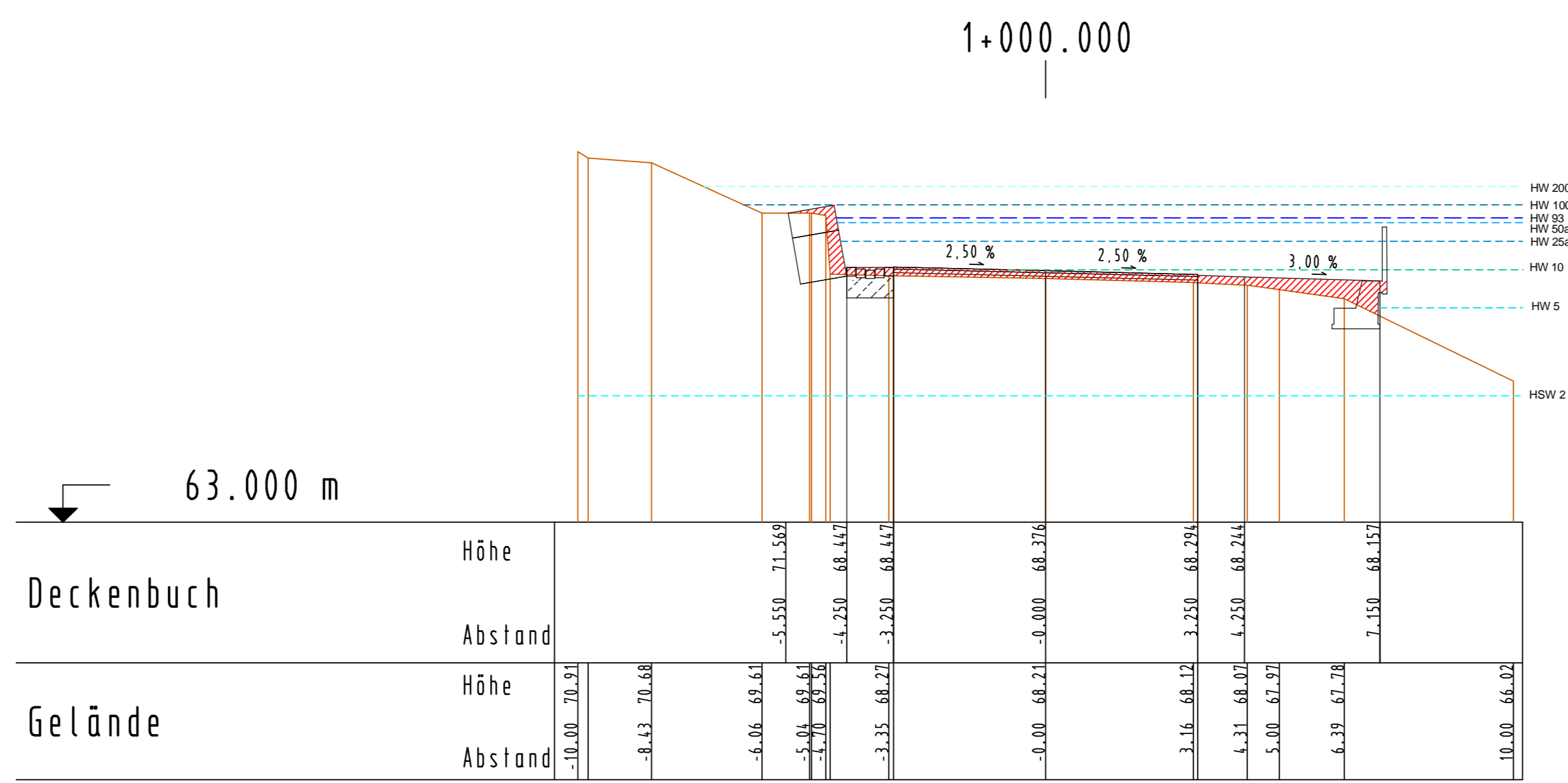
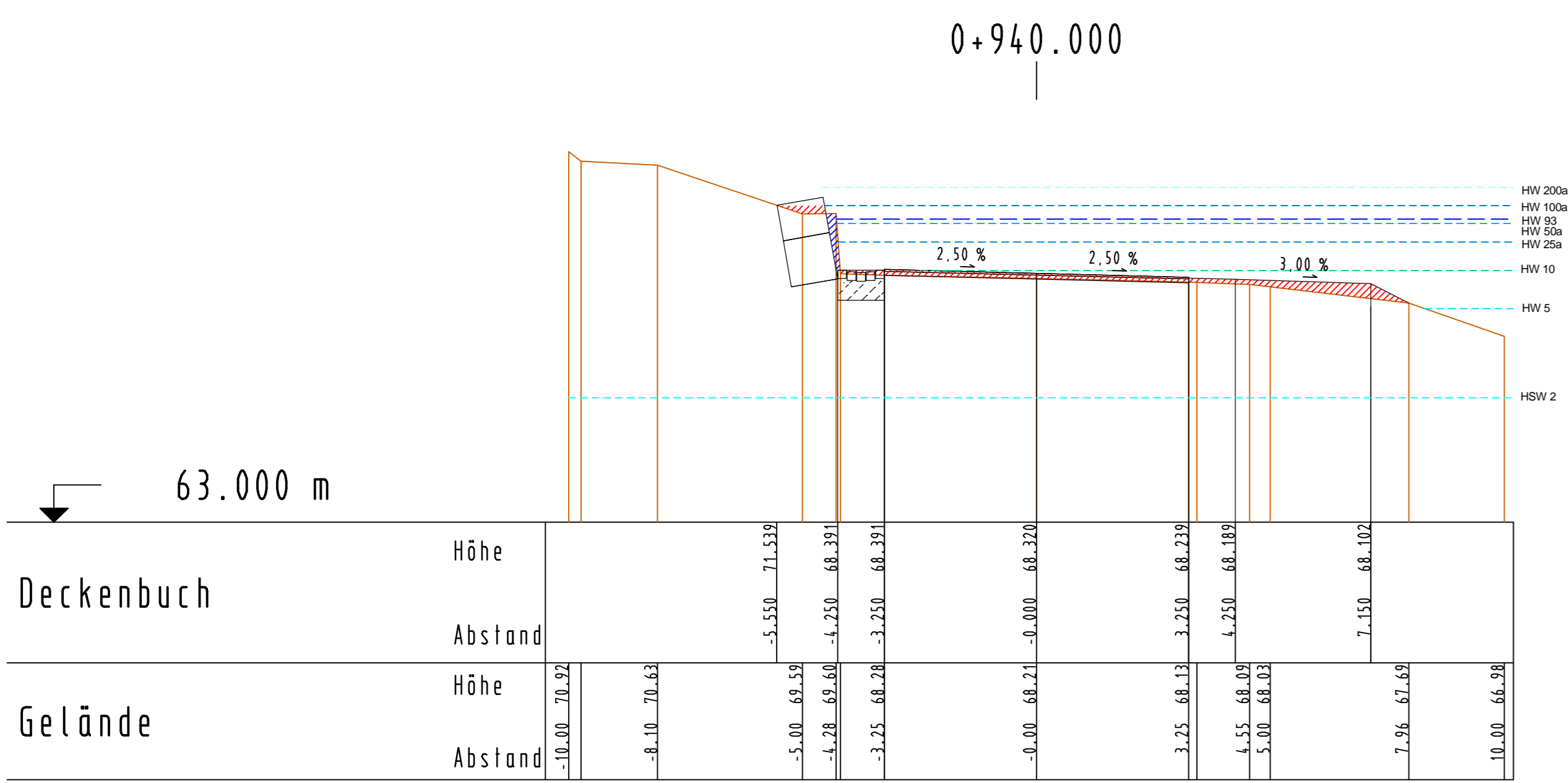
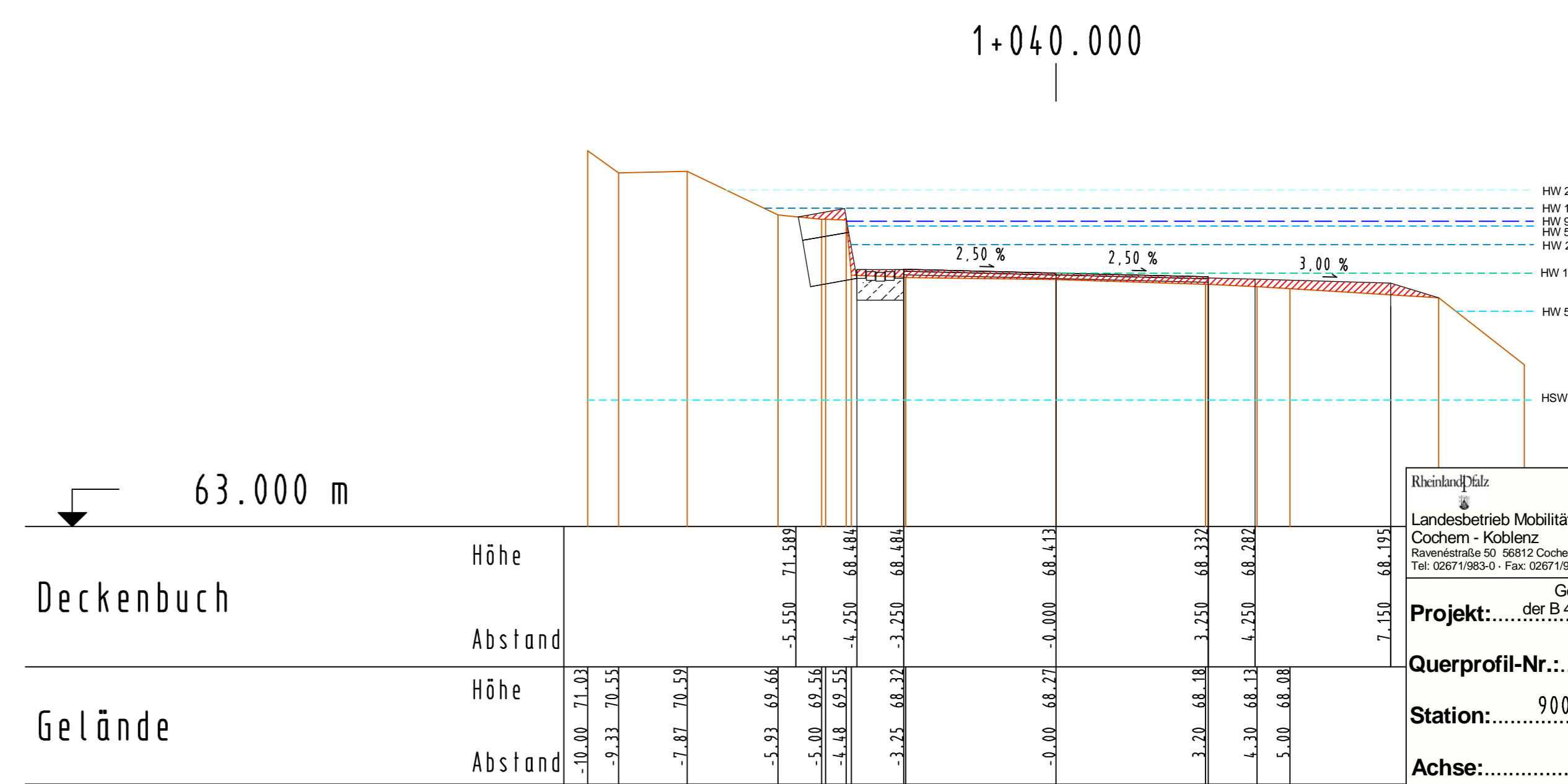
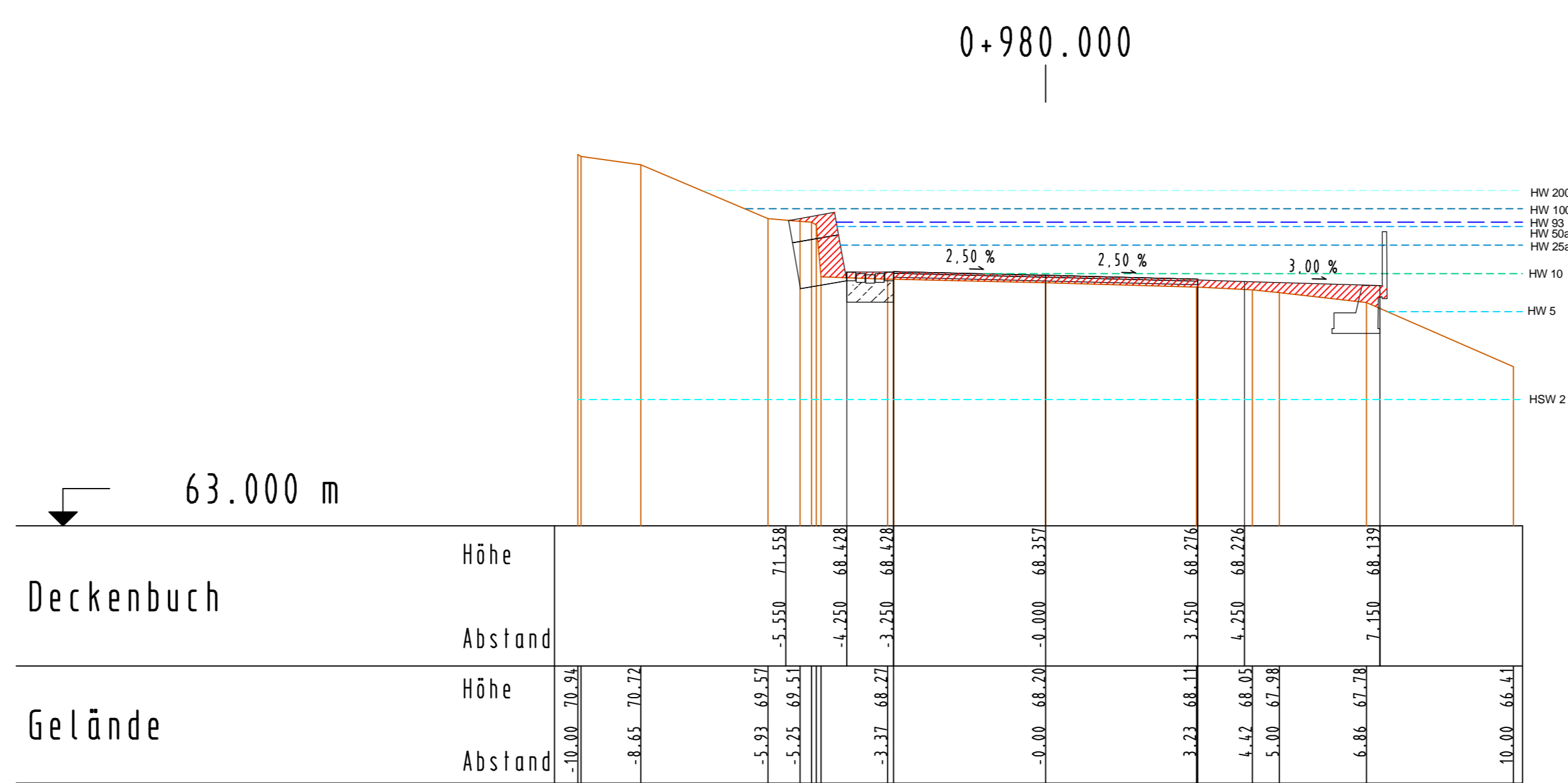
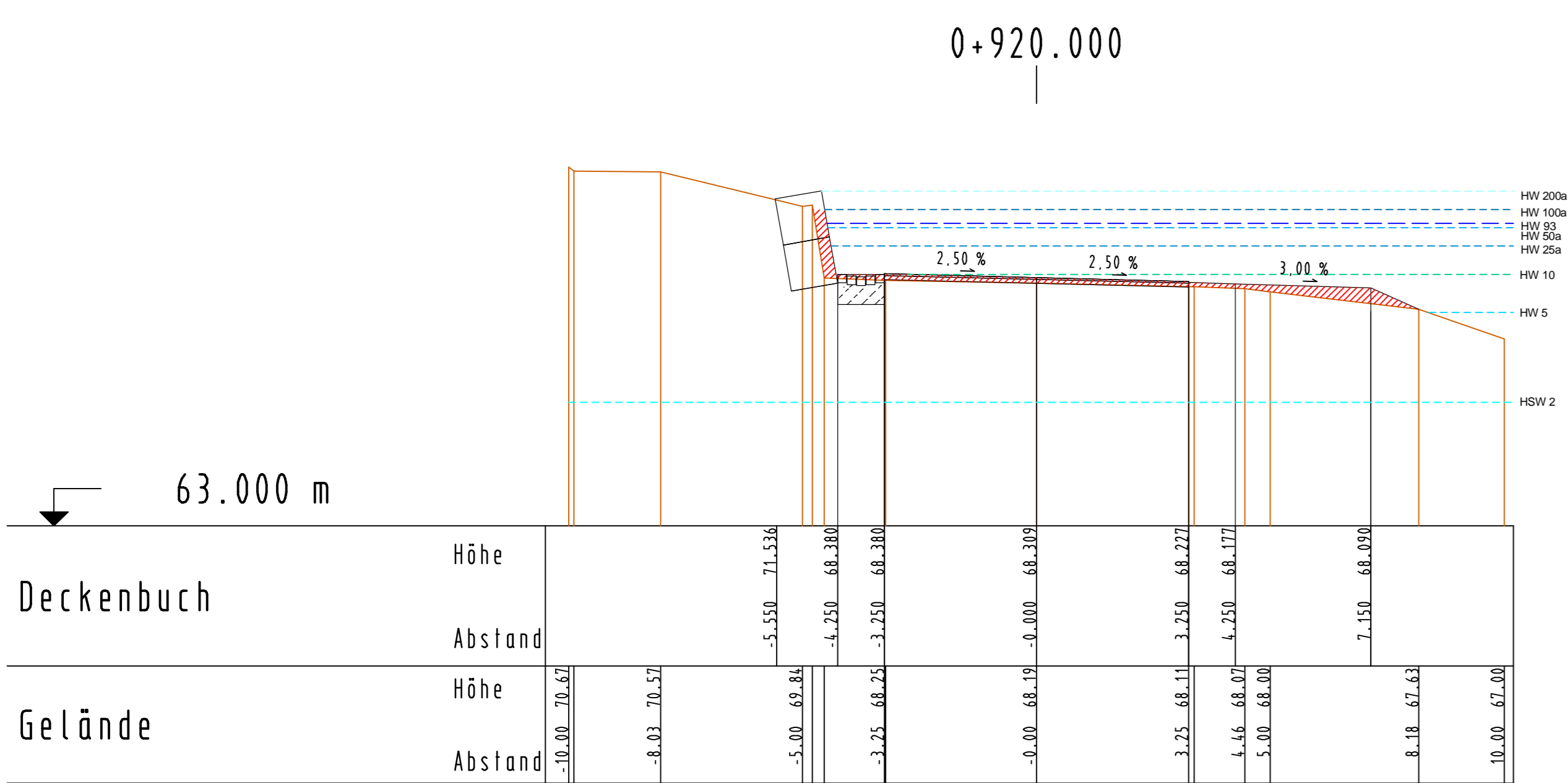
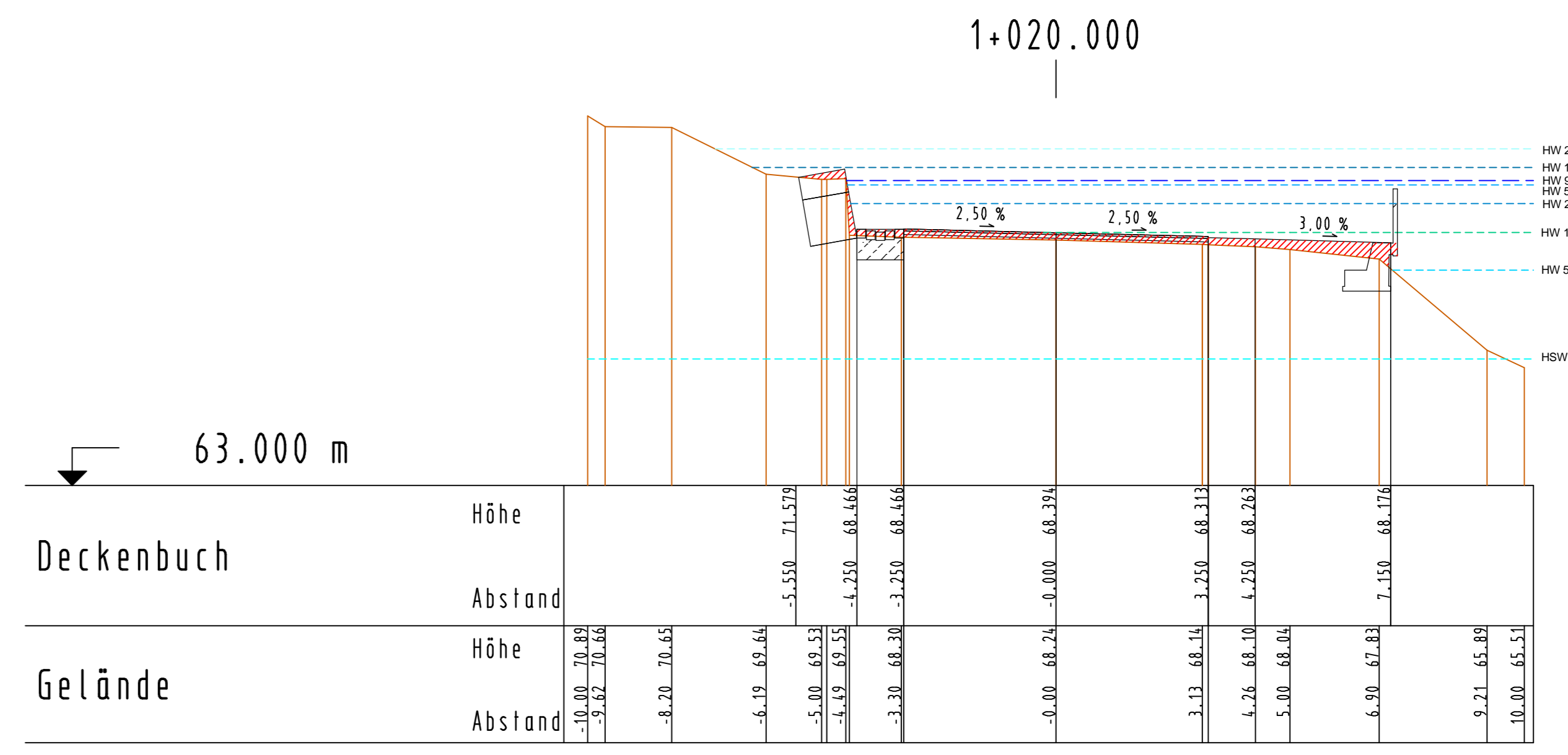
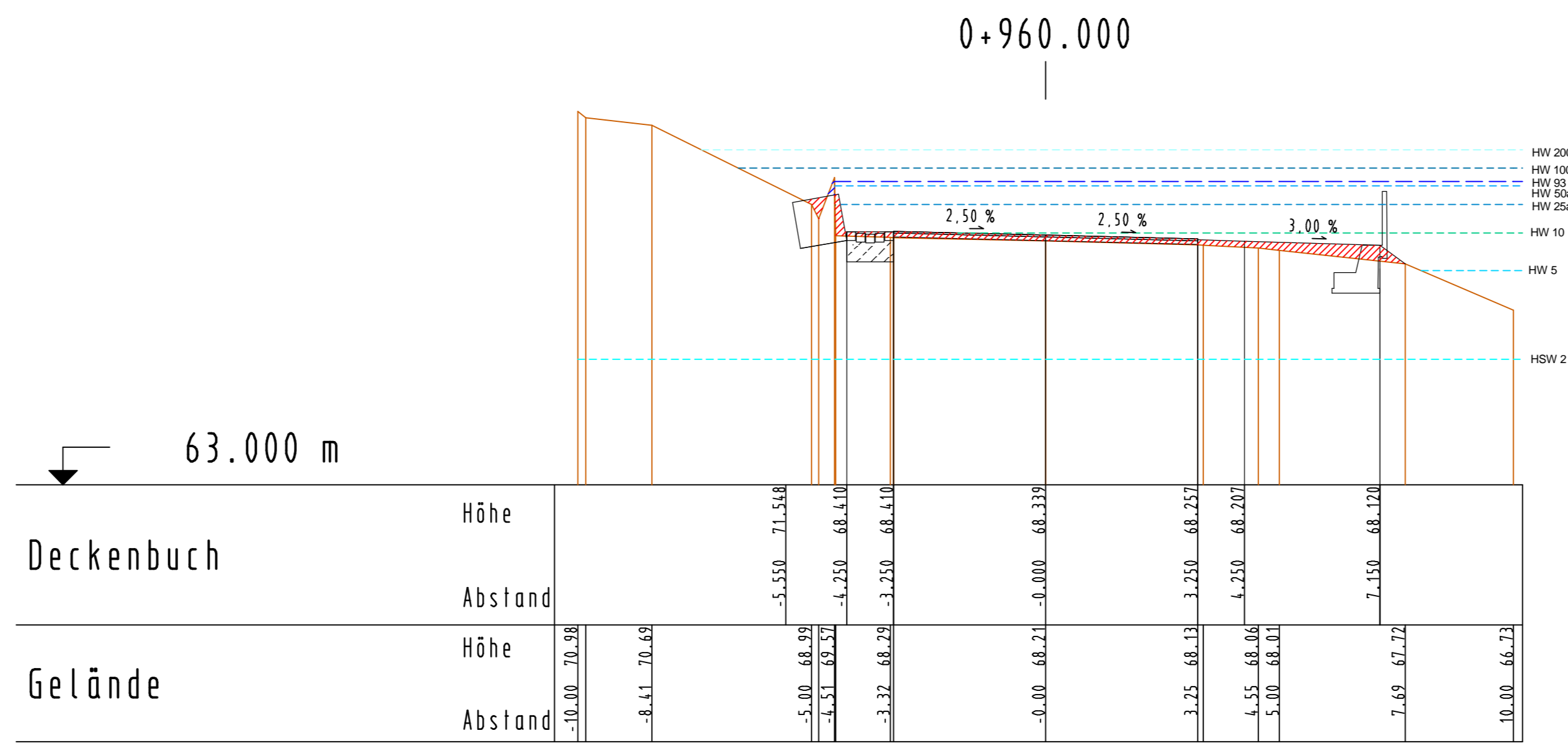
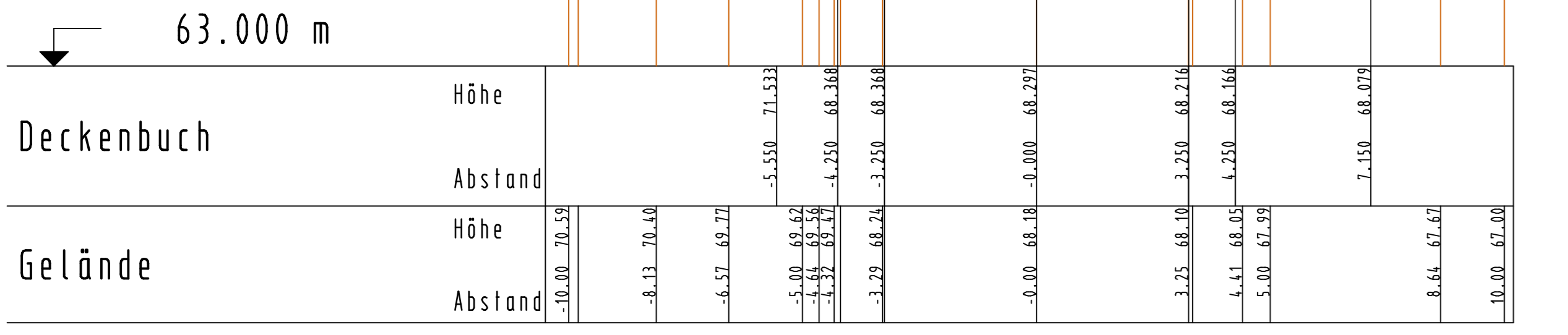
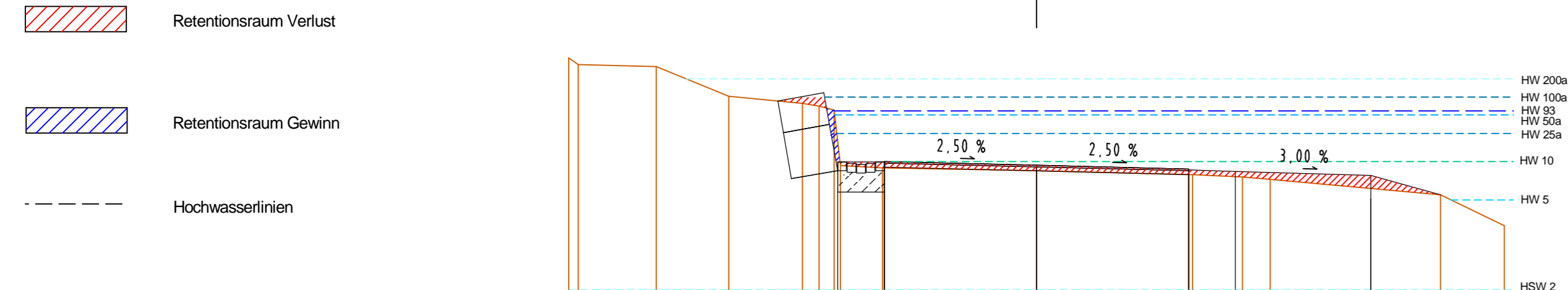

Rheinland-Pfalz  
 Landesbetrieb Mobilität  
 Cochem - Koblenz  
 Ravelsteinstraße 50, 56812 Cochem  
 Tel. 02671983-0, Fax: 02671983-200

Goh- und Radweg entlang  
 der B 49 - Koblenz Moselweiß - Lay...

Projekt-Nr.: 46 - 54  
 Station: 900.000 - 1060.000  
 Achse: 16

**Maßstab 1:100**  
 Ingenieurbüro Weinand  
 November 2014